

April 13, 2017

Life Science Innovation Network Japan, Inc. (LINK-J)

Mitsui Fudosan Co. Ltd.

Mitsui Fudosan enhances the Nihonbashi Life Science base to promote the creation of new industries in the life science realm.

Opening a shared office and small offices for venture companies to enhance services for LINK-J members

Tokyo, Japan, April 13, 2017—Mitsui Fudosan Co., Ltd. (Mitsui Fudosan) is opening new office floors in Nihonbashi Life Science Building (2-3-11 Nihonbashi, Chuo-ku; hereinafter “LSB”) and Nihonbashi Life Science Building 2 (3-11-5 Nihonbashihoncho, Chuo-ku; hereinafter “LSB2”) as part of its Nihonbashi life science innovation promotion project in collaboration with Life Science Innovation Network Japan Inc. (LINK-J). A shared office floor has opened on the fifth floor of LSB, and a floor of small offices for venture companies has opened on the fifth floor of LSB2. The Community Lounge on the tenth floor of LSB has opened as a lounge for the exclusive use of members with its amenities enhanced.

The Nihonbashi Life Science base has around 30 companies and other entities as tenants, and around 110 members use the base as a place for innovation, promoting people-to-people and technical exchanges. The enhancement of the base is intended to promote a concentration of smaller venture companies, introduce new intelligence to the base, and increase opportunities for innovation.

In addition to pre-existing partitioned small offices, the shared office in LSB has open desks that can be used around the clock for monthly fees as low as 30,000 yen*¹ and booths for personal use that can be locked. Companies and other entities can be registered, and the spaces are suitable for would-be venture companies and venture companies immediately after founding that want to hold down initial investment, as well as for universities in the provinces that want to establish a base in Tokyo. The new office floor in LSB2 has seven small spaces, each of which is 10 to 30 tsubo (33.05 to 99.17 m²). There is a meeting space that can be used free of charge, where casual meetings can be held outside offices.

The Communication Lounge on the tenth floor of LSB has begun to be used as a membership lounge that LINK-J members and tenants can use freely. The lounge has a high-end coffee machine that is available free of charge and books on life science.

In February 2017, Biomedical Solutions Inc., a venture company developing endovascular treatment devices and a tenant of LSB2, agreed to transfer all of its shares to a group company of Otsuka Holdings Co., Ltd. This is the first step toward the building of the kind of ecosystem that the Nihonbashi Life Science project seeks*². We will continue to provide an environment conducive to cooperation between different organizations in diverse fields across government, industry, and academia.



Comment of Biomedical Solutions President Kazuya Shobayashi

“Since we moved to LSB2, our connections with organizations in government, industry, and academia, primarily major pharmaceutical companies based in Nihonbashi, innovators, and investors have increased, and our trust as a life science company improved. We feel that LSB2 provides a very good environment for business and gathering information. We will continue to make contributions to health worldwide from Japan with Otsuka Group.”



Life Science Building 5F



Life Science Building2 5F

- *1: The user needs to be a LINK-J member. An initial membership fee and an annual membership fee need to be paid separately.
 *2: A system where life science companies and organizations based in Nihonbashi will create new industries through exchanges, cultivation, and collaboration

■ Outline of Nihonbashi Life Science Building share office, and the membership lounge

(Address: 2-3-11, Nihonbashi Honcho, Chuo-ku, Tokyo, 103-0023)

Share office (5F)

Commencement of use: April 3, 2017

Outline of the facility:



Charges (Monthly, excluding consumption tax)	
Open desk	30,000 yen
Personal booth for one person	70,000 yen
Personal booth for two people	110,000 yen
Other features:	
<ul style="list-style-type: none"> • Can be used around the clock. • Wi-Fi is available. • Electricity charge and air-conditioning charge are included. • No security deposits • Commercial registration is possible. 	
*An initial LINK-J membership fee and an annual membership fee need to be paid separately.	

Membership lounge (10F)

On April 3, 2017, the membership lounge opened as a lounge for the exclusive use of LINK-J members. The lounge can be used freely from 8:00 to 22:00. There is a semi-private room for meetings. A coffee counter, offering good coffee, tea, and other drinks and nuts and confectionery (paid) together with a library of books related to life science have been added. The lounge is a comfortable space for people engaged in life science business.

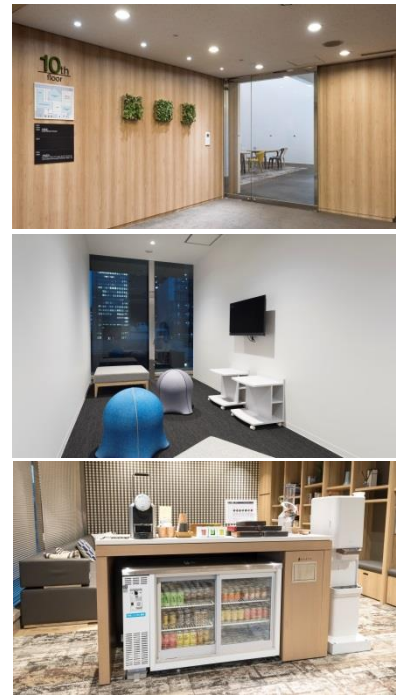

■ Outline of offices for venture companies (5F) Nihonbashi Life Science Building 2 (31 VENTURES)

(Address: 3-11-5, Nihonbashi Honcho, Chuo-ku, Tokyo, 103-0023)

Commencement of use: February 13, 2017

Outline of the facility:

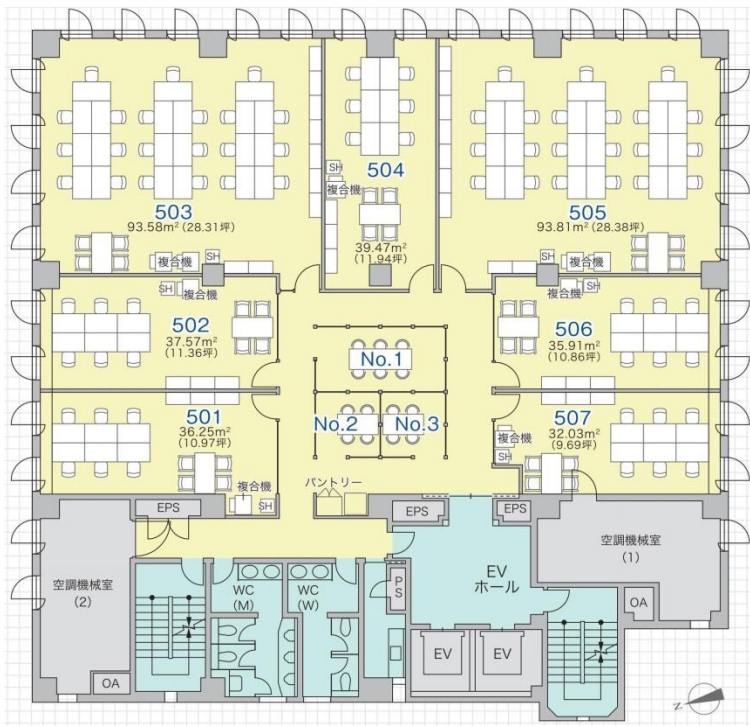

Outline of the facility	
Transportation:	
<ul style="list-style-type: none"> • Three-minute walk from Shinnihonbashi Station on the JR line • Three-minute walk from Kodenmacho Station on the Hibiya line • Five-minute walk from Mitsukoshi-mae Station on the Hanzomon Line and Ginza Line 	
Rentable space	9.69~28.88 tsubo (32.03~95.47 m ²)
Other features:	
<ul style="list-style-type: none"> • The security deposit is the rent for three months. • Electricity charges and air-conditioning charges in and outside the business hours are included in rents. 	

*An initial LINK-J membership fee and an annual membership fee need to be paid separately.

Major tenants of the Nihonbashi Life Science base (as of April 13, 2017; in a random order)

【Nihonbashi Life Science Building】

Floor	Tenants
10F	Life Science Innovation Network Japan, Inc.
9F	Osaka University, Kyoto University, The University of Tokyo, Tohoku University, UC San Diego
8-7F	Japan Pharmaceutical Manufacturers Association
6F	Tokyo Medical-Industrial Cooperation Innovation Center, Forum for Innovative Regenerative Medicine, DIA Japan, Japanese Organization for Medical Device Development, Inc., Pharmaceutical Development Support Center
5F	MinaCare, Japan CRO Association, Alliance Forum Foundation, Japan Biological Informatics Consortium *All of them are tenants of small office spaces.
4F	The Systems Biology Institute, Quantum Biosystems, Tsujimaru International Patent Office, The Japanese Society for Regenerative Medicine, Health Care Stability and Regional Economy Vitalization Forum, Biopharma Forest Inc.

【Nihonbashi Life Science Building 2(31 VENTURES)】

Floor	Tenants
6F	INDEE Medical Inc., KinoPharma Inc., Delta-Fly Pharma Inc., Med Vision, Biomedical Solutions, Commons for Medicine and Engineering Japan
5F	Glycobiomarker Leading Innovation Co. Ltd., Biomedical Solutions

*Biomedical Solutions Inc. has its space on the fifth and sixth floors.

【Nihonbashi Life Science Hub】

Floor	Tenants
8F	Department of Innovative Drug Discovery and Development, East Japan Office, Japan Agency for Medical Research and Development(AMED)

■ About Life Science Innovation Network Japan, Inc. (LINK-J)

LINK-J is a general incorporated association established by Mitsui Fudosan and volunteers from academic circles. With its base in the Nihonbashi area, where a number of pharmaceutical companies are clustered, LINK-J aims to promote open innovation in the life science realm through industry-government-academia cooperation and extend support to the creation of new industries. Across the entire life science area, i.e., the area where all sciences are combined, ranging from medicine to science and further to engineering or new technologies, such as information and communication technology (ICT) or artificial intelligence (AI), it will accelerate interdisciplinary human and technological exchanges.

■ Nihonbashi Life Science base

Mitsui Fudosan has created the following life science bases in Nihonbashi.

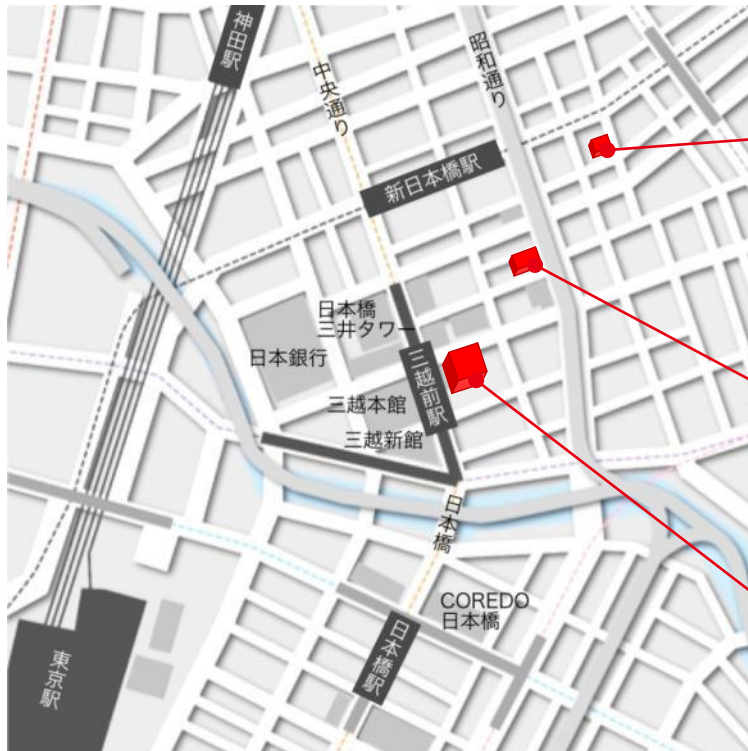

Life Science Building 2
(31 VENTURES)



Nihonbashi Life Science Building



Nihonbashi Life Science Hub

